



**Size: 19.685" x 17.5"**

Please Read and Save this Use and Care Book.

## IMPORTANT SAFEGUARDS

When using electrical appliances, basic safety precautions should always be followed, including the following:

- Read all instructions.
- To protect against risk of electrical shock do not immerse cord, plugs or appliance in water or other liquid.
- Close supervision is necessary when any appliance is used by or near children.
- Unplug from outlet when not in use, before putting on or taking off parts, and before cleaning.
- Avoid contacting moving parts.
- Do not operate any appliance with a damaged cord or plug or after the appliance malfunctions, or is dropped or damaged in any manner. Return appliance to the nearest authorized service facility or call the appropriate toll-free number on the front of this manual for examination, repair or electrical or mechanical adjustment.
- The use of attachments, including canning jars, not recommended by the manufacturer may cause fire, electric shock or injury.
- Do not use outdoors.
- Do not let cord hang over edge of table or counter.
- Keep hands and utensils out of container while blending to reduce the risk of severe injury to persons or damage to the blender. A scraper may be used, but must be used only when the blender is not running.
- Blades are sharp. Handle carefully.
- To reduce the risk of injury, never place cutter-assembly blades on base without jar properly attached.
- Always operate blender with cover in place.
- When blending hot liquids, remove center piece of two-piece cover.
- This appliance is not intended for use by persons (including children) with reduced physical, sensory or mental capabilities, or lack of experience and knowledge, unless they have been given supervision or instruction concerning use of the appliance by a person responsible for their safety.
- Children should be supervised to ensure that they do not play with the appliance.

## Care and Cleaning

This product contains no user serviceable parts. Refer service to qualified service personnel.

### CLEANING

1. Before cleaning, turn off and unplug the unit. Twist to unlock (↻), lift the jar off the unit base and rinse. For easier cleanup, rinse parts immediately after blending. Parts may be hand-washed.
2. Do not immerse the base in liquid. Wipe the unit base with a damp cloth and dry thoroughly. Remove stubborn spots by rubbing with a damp cloth and nonabrasive cleaner.
3. Removable parts can be washed by hand or in a dishwasher. Lid, lid cap and blade assembly should be placed in the top rack only. The jar is bottom rack dishwasher-safe. Do not place jar or parts in boiling liquids.

**Note:** If liquids spill into the base, wipe with a damp cloth and dry thoroughly. Do not use rough scouring pads or cleansers on parts or finish.

## SAVE THESE INSTRUCTIONS.

This product is for household use only.

### POLARIZED PLUG (120V Models Only)

This appliance has a polarized plug (one blade is wider than the other). To reduce the risk of electric shock, this plug is intended to fit into a polarized outlet only one way. If the plug does not fit fully into the outlet, reverse the plug. If it still does not fit, contact a qualified electrician.

Do not attempt to modify the plug in any way.

### TAMPER-RESISTANT SCREW

**Warning: This appliance is equipped with a tamper-resistant screw to prevent removal of the outer cover. To reduce the risk of fire or electric shock, do not attempt to remove the outer cover. There are no user-serviceable parts inside. Repair should be done only by authorized service personnel.**

### ELECTRICAL CORD

- a) A short power-supply cord (or detachable power-supply cord) is to be provided to reduce the risk resulting from becoming entangled in or tripping over a longer cord.
- b) Longer detachable power-supply cords or extension cords are available and may be used if care is exercised in their use.
- c) If a long detachable power-supply cord or extension cord is used,
  - 1) The marked electrical rating of the detachable power-supply cord or extension cord should be at least as great as the electrical rating of the appliance,
  - 2) If the appliance is of the grounded type, the extension cord should be a grounding-type 3-wire cord, and
  - 3) The longer cord should be arranged so that it will not drape over the countertop or tabletop where it can be pulled on by children or tripped over.

**Note:** If the power supply cord is damaged, it should be replaced by qualified personnel

Product may vary slightly from what is illustrated.

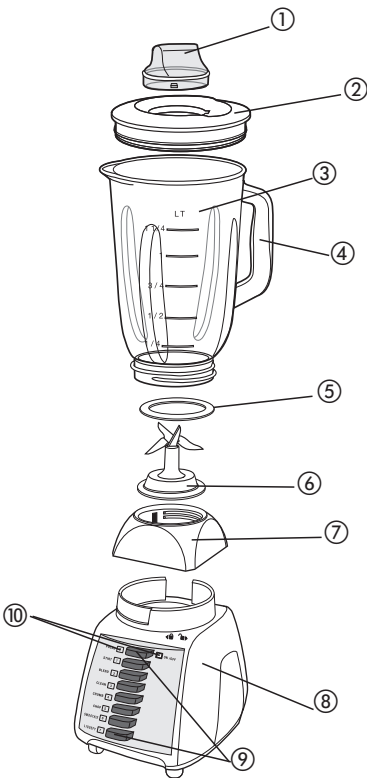

1. Lid cap
2. Lid
3. 42-oz./5-cup glass jar
4. Handle
5. Gasket
6. Blade assembly
7. Jar base
8. Unit base
9. Speed buttons
10. Pulse and On/Off button

### Póliza de Garantía

(Válida sólo para México)

#### Duración

Spectrum Brands de México SA de CV este producto por 2 años a partir de la fecha original de compra.

#### ¿Qué cubre esta garantía?

Esta Garantía cubre cualquier defecto que presenten las piezas, componentes y la mano de obra contenidas en este producto.

#### Requisitos para hacer válida la garantía

Para reclamar su Garantía deberá presentar al Centro de Servicio Autorizado la póliza sellada por el establecimiento en donde adquirió el producto. Si no la tiene, podrá presentar el comprobante de compra original.

#### ¿Donde hago válida la garantía?

Llame sin costo al teléfono 01 800 714 2503, para ubicar el Centro de Servicio Autorizado más cercano a su domicilio en donde usted podrá encontrar partes, componentes, consumibles y accesorios.

#### Procedimiento para hacer válida la garantía

Acuda al Centro de Servicio Autorizado con el producto con la póliza de Garantía sellada o el comprobante de compra original, ahí se reemplazará cualquier pieza o componente defectuoso sin cargo alguno para el usuario final. Esta Garantía incluye los gastos de transportación que se deriven de su cumplimiento.

#### Excepciones

Esta Garantía no será válida cuando el producto:

- A) Se hubiese utilizado en condiciones distintas a las normales.
- B) No hubiese sido operado de acuerdo con el instructivo de uso que le acompaña.
- C) Cuando el producto hubiese sido alterado o reparado por personas no autorizadas por Spectrum Brands de México SA de CV.

**Nota:** Usted podrá encontrar partes, componentes, consumibles y accesorios en los centros de servicios autorizados. Esta garantía incluyen los gastos de transportación que se deriven de sus cumplimiento dentro de sus red de servicio.

### BLENDER JAR ASSEMBLY

1. After unpacking the blender, before first use, wash all parts except the unit base.
2. Remove and save literature.
3. Put the gasket on top of the blade assembly.
4. Place the blade assembly into the jar base and turn the jar base clockwise until tight (A).
5. **Interlock System:** Place the assembled jar onto the unit base and turn toward the lock symbol (🔒) until secured in place. You have engaged the interlock system if you lift the jar handle and the entire blender lifts together as one unit.

## How to Use

This product is for household use only.

**Note:** Your unit has an intelligent fuse system designed to protect the motor from overheating. It automatically shuts off the motor and resets the unit. Simply wait a moment, unplug the unit then plug again to restart operation.

1. Make sure the unit is off and plug the cord into a standard electrical outlet.
  2. Place the food into the jar and the lid on the jar before blending.
  3. Make sure that the lid cap is in place.
- Note:** When crushing hard foods, keep one hand on the lid.
4. Choose the speed that best suits your task for food or beverage blending (B).
  5. When finished blending, press the  (on/off) button.
  6. For quick or delicate blending tasks use the **P** (pulse) button for a few seconds, then release. Releasing the Pulse button automatically turns off the blender.
  7. To add ingredients while the blender is on, remove the lid cap and drop ingredients through the lid opening.
8. To remove the jar, grasp the handle, twist toward the unlock symbol (🔓) and lift it from the unit base.
9. Remove the lid before pouring.

### BLENDING TIPS AND TECHNIQUES

- Cut food into small pieces 3/4" (2 cm) before adding to the blender.
- When ingredients stick or splatter along the sides of the jar, stop the blending action and remove the lid. Use a rubber spatula to push food toward the blades. Replace the lid, then continue blending.
- Some of the tasks that cannot be performed efficiently with a blender are: beating egg whites, whipping cream, mashing potatoes, mixing dough and extracting juices from fruits and vegetables.
- The following items should never be placed in the appliance as they may cause damage: dried spices and herbs (ground alone), bones, large pieces of solidly frozen foods and tough foods such as turnips.
- Use the lid cap to measure ingredients up to 60 ml (2 oz.) when adding ingredients like lemon juice, cream or liqueurs.

Por favor llame al número correspondiente que aparece en la lista a continuación para solicitar que se haga efectiva la garantía y donde Ud. puede solicitar servicio, reparaciones o partes en el país donde el producto fué comprado.	
<b>Argentina</b> Atención al consumidor 0800 444 7296 Horario de atención: Lunes a viernes de 9 a 13 hs y de 14.30 a 17 hs. email:servicios@spectrumbrands.com Humboldt 2495 piso 3 C.A.B.A. – Argentina	<b>Honduras</b> Serviteca San Pedro Sula, B Los Andes, 2 calle -entre 11-12 Avenida Honduras Tel. (504) 2550-1074
<b>Chile</b> SERVICIO DE MAQUINAS Y HERRAMIENTAS LTDA. Portugal N° 644 Santiago – Chile Fonos: 02-6355208 / 02-6341169 Email: servicio@spectrumbrands.cl Call center: 800-171-051	<b>México</b> Artículo 123 # 95 Local 109 y 112 Col. Centro, Cuauhtemoc, México, D.F. Tel. 01 800 714 2503
<b>Colombia</b> Rayovac Varta S.A Carrera 17 Número 89-40 Línea gratuita nacional 018000510012	<b>Nicaragua</b> LRM ELECTRONICA Managua - Sinsa Altamira 1.5 kilómetros al norte Nicaragua Tel. (505) 2270-2684
<b>Costa Rica</b> Aplicaciones Electromecánicas Calle 22 y 24 en Avenida 3 BLV de la torre Mercedes Benz 200 mts norte y 50 mts este San José, Costa Rica Tel. (506) 2257-5716	<b>Panamá</b> Supermarcas Centro comercial El dorado, Plaza Dorado, Local 2. Panama Tel. (507) 392-6231 Perú Servicio Central Fast Service Av. Angamos Este 2431 San Borja, Lima Perú Tel. (511) 2251-388
<b>Ecuador</b> Servicio Master Dirección: Capitán Rafael Ramos OE 1-85 y Galo plaza Iasso. Tel (593) 2281-3882 / 2240-9870	<b>Puerto Rico</b> Buckeye Service Jesús P. Piñero #1013 Puerto Nuevo, SJ PR 00920 Tel.: (787) 782-6175
<b>El Salvador</b> Sedeblock Calle San Antonio Abad, Colonia Lisboa No 2936 San Salvador, Depto. de San Salvador Tel. (503) 2284-8374	<b>Republica Dominicana</b> Prolongación Av. Rómulo Betancourt Zona Industrial de Herrera Santo Domingo, República Dominicana Tel.: (809) 530-5409
<b>Guatemala</b> Kinal 17 avenida 26-75, zona 11 Centro comercial Novicentro, Local 37 - Ciudad Guatemala Tel. (502)-2476-7367	<b>Venezuela</b> Inversiones BDR CA Av. Casanova C.C. City Market Nivel Plaza Local 153 Diagonal Hotel Meila, Caracas. Tel. (582) 324-0969