

REMINGTON®

AIR3D HAIR DRYER



USE & CARE
MANUAL

PLEASE READ
PRIOR TO USE

To register your product go to
www.remington-products.com.au
www.remington.co.nz

3 YEAR WARRANTY

D7777AU

IMPORTANT SAFEGUARDS

WARNING: WHEN THE HAIR DRYER IS USED IN A BATHROOM, UNPLUG IT AFTER USE SINCE THE PROXIMITY OF WATER PRESENTS A HAZARD EVEN WHEN THE HAIR DRYER IS SWITCHED OFF.

WHEN USING ELECTRICAL APPLIANCES, ESPECIALLY WHEN CHILDREN ARE PRESENT, BASIC SAFETY PRECAUTIONS SHOULD ALWAYS BE FOLLOWED, INCLUDING THE FOLLOWING:

READ ALL INSTRUCTIONS BEFORE USING
KEEP AWAY FROM WATER

DANGER: AS WITH MOST ELECTRICAL APPLIANCES, ELECTRICAL PARTS ARE ELECTRICALLY LIVE EVEN WHEN THE SWITCH IS OFF.

To reduce the risk of death by electric shock:

- Always unplug it immediately after using.
- Do not place or store an appliance where it can fall or be pulled into a bath or sink.
- Do not use while bathing.
- Do not place or drop into water or other liquid.
- If an appliance falls into water, “unplug it” immediately. Do not reach into the water.

WARNING: TO REDUCE THE RISK OF BURNS, ELECTROCUTION, AND FIRE, OR INJURY TO PERSONS.

- Your hair dryer should never be left unattended when plugged in to a power outlet.
- This appliance is not intended for use by persons (including children) with reduced physical, sensory or mental capabilities, or lack of experience and knowledge, unless they have been given supervision or instruction concerning use of the appliance by a person responsible for their safety.

- Keep the appliance and the power cord away from the edge of table or countertops and out of reach of children and persons with reduced physical, sensory or mental capabilities.
- This appliance is not a toy. Children shall be supervised to ensure they do not play with the appliance. Cleaning and user maintenance shall not be made by children without supervision.
- Use this appliance only for its intended use as described in this manual. Do not use attachments not recommended by Remington.
- If the supply cord is damaged, it must be replaced by the manufacturer, its service agents or similarly qualified persons in order to avoid a hazard.
- Do not use on people who are asleep.
- Never drop or insert any object into any opening of this appliance.
- Do not use outdoors or where aerosol (spray) products are being used or where oxygen is being administered.
- Do not direct hot air towards the eyes or other heat sensitive areas.
- Attachments provided may be hot during and after use, allow them to cool before handling or storing away.
- When using the appliance, keep your hair away from the air inlet grille. Do not let your hair get drawn into the appliance.
- Do not use this appliance near bathtubs, showers, basins or other places containing water.

FOR ADDITIONAL PROTECTION, THE INSTALLATION OF A RESIDUAL CURRENT DEVICE (RCD) WITH A RATED RESIDUAL OPERATING CURRENT NOT EXCEEDING 30MA IS ADVISABLE IN THE ELECTRICAL CIRCUIT SUPPLYING THE BATHROOM. ASK YOUR ELECTRICAL CONTRACTOR FOR ADVICE.

SAVE THESE INSTRUCTIONS

D7777AU AIR3D HAIR DRYER

Use & Care Instruction Manual

Thank you for purchasing your new Remington® AIR3D Hair Dryer. Featuring unique 3D airflow and Smooth Conditioning Technology, AIR3D is our next generation hair dryer for fast smooth styling.

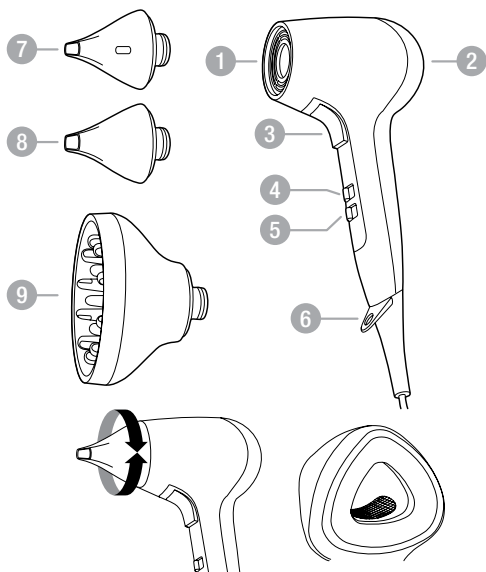

KEY PARTS

- | | |
|----------------------------|----------------------------------|
| 1. Ceramic back-lit grille | 6. Hang loop |
| 2. Air inlet grille | 7. 7mm Ultra slim concentrator |
| 3. Cool shot | 8. 11mm Fast drying concentrator |
| 4. Heat settings (☹☹☹) | 9. Diffuser |
| 5. Speed settings (🌀) | 10. Storage pouch (not shown) |

UNIQUE 3D AIRFLOW TECHNOLOGY

AIR3D features a unique design with 3D Airflow Technology to deliver precise, evenly heated airflow for optimal styling performance.

SMOOTH CONDITIONING TECHNOLOGY

Besides the ionic generator, this hair dryer is infused with micro-conditioners to eliminate static hair, smooth down the hair cuticles for intensified softness, achieving the ultra-smooth finish.

LIGHTWEIGHT & BALANCED

With the motor located vertically in the handle, this hair dryer allows optimised weight distribution to provide maximum comfort and control.

USE INSTRUCTIONS

- Wash and condition your hair as normal.
- Squeeze out excess moisture with a towel and comb through.

NOTE: Hairsprays contain flammable material - do not use while using this product.

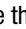
1. Plug the hair dryer into the power supply.
2. Switch the hair dryer on and select the desired Speed Setting (1 Low or 2 High) using the speed setting switch (). The number below the switch will light up to show you which setting you have selected. The back-lit grille will light up white when you switch the hair dryer on.
3. Select the desired Heat Setting (1 Low, 2 Medium or 3 High) using the heat setting switch (). The number above the switch will light up and show you which setting you have selected.
4. Press and hold the cool shot button to direct cool air onto your hair to help set your style. The back-lit grille will illuminate blue when you use the cool shot feature.
5. After use, turn your hair dryer off and unplug it.
6. Let your hair dryer cool down before cleaning or storing away.

FITTING ATTACHMENTS

1. Push the desired attachment onto the front of your hair dryer.
2. Concentrator can be rotated as required.

QUICK DRYING

Select a high heat & speed setting and roughly dry your hair. Use a brush or your hand to shake out excess moisture whilst drying and keep the hair dryer in constant motion.

STRAIGHTENING

Select high heat and roughly dry the hair. When the hair is nearly dry, attach the concentrator nozzle (which minimises frizz) and reduce the heat & speed. Section the hair according to thickness and begin with straightening bottom layers first. Using your brush, follow the concentrator from above, while slowly gliding down each section of hair from roots to tips. Once bottom layers have been straightened, then straighten the mid section and complete by straightening top layers.

NATURAL WAVY TEXTURE

Using a low heat/speed setting, 'scrunch' sections of hair with your fingers into the palm of your hand while directing airflow through your fingers. Once you have reached the desired effect, use the cool shot on each section of hair to hold style. For more volume lean forward and dry hair in the upside down position.

LIFT & VOLUME

Use the hair dryer on a low heat/speed setting, work from the roots of hair and begin at the back of the head. Section your hair and use a round brush to dry against the natural growth pattern of your hair. This creates lift at the roots, which creates a style with volume.

STYLING

Set the hair dryer to a low heat setting and attach the concentrator nozzle for precision drying. Section the hair and style using a round brush. Concentrate the airflow directly on the hair while styling in the direction you desire. If necessary, hold the airflow for 2-5 seconds on each section while curling under or over for additional hold.

USING THE DIFFUSER

This hair dryer comes with a professional style diffuser. This diffuser dries hair fast without blowing out the style. Perfect for naturally curly, wavy, permed and fine hair or to give your hair a boost for volume.

NOTE: Always select the lowest heat setting when using the diffuser, as damage may occur to the diffuser if higher heat settings are used.

DRY YOUR HAIR USING THE DIFFUSER

Dry your hair beginning at the roots and using the circular motions, always moving in the same direction. Use the diffuser with the hair dryer set at low heat and low speed. Continue drying, keeping the hair dryer at a 90-degree angle to the scalp. This will lift the roots away from the scalp giving your hair volume. Finish by drying the ends.

ADD VOLUME TO YOUR HAIR USING THE DIFFUSER

To add volume to your hair, tilt your head upside down and dry so that the roots fall away from your scalp. Use the diffuser with the hair dryer set at low heat and low speed. Point the hair dryer at the roots to give your hair maximum volume. Continue the process to the ends of your hair.

CLEANING AND MAINTENANCE

To maintain peak product performance and to prolong motor life, it is important to regularly clean the air inlet grille.

- Unplug the hair dryer and allow it to cool.
- Use a lint free cloth or soft brush to gently remove dust and debris from the grille.

STORAGE

When not in use, always unplug the hair dryer from the power outlet. Allow the hair dryer to cool and store out of the reach of children in a safe dry place. Never wrap the power cord around the hair dryer since this will cause the cord to wear prematurely and break. Handle the cord carefully for long life and avoid jerking, twisting or straining especially at the plug connections. If the cord becomes twisted in use, periodically straighten it.

You may also use the hang loop to store the hair dryer within convenient reach, ensuring that water cannot be splashed on to it when it is hung up. Alternatively you may also store it in the storage pouch that comes with the hair dryer.



WARNING: Do not use this appliance near bathtubs, showers, basins or other vessels containing water.

As with all electrical appliances, the power cord must be regularly checked for wear and tear. Immediately cease using this product if the power cord shows any signs of damage.

This product conforms to radio frequency interference requirements.
Any product purchased and used commercially carries a limited 90 Day Warranty.

WARRANTY AGAINST DEFECTS

In this warranty:

Australian Consumer Law means the Australian consumer law set out in Schedule 2 to the Competition and Consumer Act 2010;

CGA means the New Zealand Consumer Guarantees Act 1993;

Goods means the product or equipment which was accompanied by this warranty and purchased in Australia or New Zealand, as the case may be;

Manufacturer, We or us means:

1. for Goods purchased in Australia, Spectrum Brands Australia Pty Ltd
ACN, 007 070 573; or
2. for Goods purchased in New Zealand, Spectrum Brands New Zealand Limited,
as the case may be, contact details as set out at the end of this warranty;

Supplier means the authorised distributor or retailer of the Goods that sold you the Goods in Australia or in New Zealand; and

You means you, the original end-user purchaser of the Goods.

1. Our goods come with guarantees that cannot be excluded under the Australian Consumer Law, or the CGA. You are entitled to a replacement or refund for a major failure and compensation for any other reasonably foreseeable loss or damage. You are also entitled to have the goods repaired or replaced if the goods fail to be of acceptable quality and the failure does not amount to a major failure.
2. The benefits provided by this Warranty are in addition to all other rights and remedies in respect of the Goods which the consumer has under either the Australian Consumer Law or the CGA. The original purchaser of the Goods is provided with the following Warranty subject to the Warranty Conditions:
3. We warrant the Goods for all parts defective in workmanship or materials for the period of three (3) years from the date of purchase (**Warranty Period**). If the Goods prove defective within the Warranty Period by reason of improper workmanship or material, we may, at our own discretion, repair or replace the Goods without charge.

Warranty Conditions

4. The Goods must be used in accordance with the manufacturer's instructions. This Warranty does not apply should the defect in or failure of the Goods be attributable to misuse, abuse, accident or non-observance of manufacturer's instructions on the part of the user. As far as the law permits, the manufacturer does not accept liability for any direct or consequential loss, damage or other expense caused by or arising out of any failure to use the Goods in accordance with the manufacturer's instructions.
5. Consumable parts (such as shaver heads, cutters and foils) of the Goods are included under this Warranty only where there is a defect in workmanship or materials used.
6. The warranty granted under clause 3 is limited to repair or replacement only.
7. Any parts of the Goods replaced during repairs or any product replaced remain the property of the manufacturer. In the event of the Goods being replaced during the Warranty Period, the warranty on the replacement Goods will expire on the same date as for the Warranty Period on the original Goods which are replaced.

8. In order to claim under the warranty granted under clause 3 you must:
 - (a) Retain this warranty with your receipt/proof of purchase; and
 - (b) Return the Goods to us at the relevant address below or to the Supplier by prepaid freight within the Warranty Period accompanied with (i) the legible and unmodified original proof of purchase, which clearly indicates the name and address of the Supplier, the date and place of purchase, the product name or other product serial number and (ii) this warranty.
9. This warranty is immediately void if:
 - (a) Any serial number or appliance plate is removed or defaced;
 - (b) The Goods have been serviced or otherwise repaired by a person not authorised to do so by us or where non approved replaced parts are used.
10. The Goods are designed for domestic use only. A limited 90-day Warranty applies to any industrial or commercial use of the Goods. The Goods must be connected to the electrical voltage requirements as specified in the ratings label located on the Goods.
11. This warranty does not cover the cost of claiming under the warranty or transport of the Goods to and from the Supplier or us.
12. This warranty is only valid and enforceable in Australia against Spectrum Brands Australia Pty Ltd and in New Zealand against Spectrum Brands New Zealand Limited.

Contact us or the Supplier for further details.

Spectrum Brands Australia Pty Ltd

Locked Bag 3004

Braeside, VIC 3195

AUSTRALIA

Customer service in Australia: 1800 623 118

E-mail: consumer.enquiry@remington-products.com.au

Website: www.remington-products.com.au

Spectrum Brands New Zealand Limited

PO Box 9817

Newmarket, Auckland 1149

NEW ZEALAND

Customer service in New Zealand: 0800 736 776

E-mail: info@remington.co.nz

Website: www.remington.co.nz

REMINGTON

REMINGTON SERVICE HOTLINE

① Australia 1800 623 118 (toll free)

① New Zealand 0800 736 776 (toll free)

® Registered Trademark of Spectrum Brands, Inc. or one of its subsidiaries

©2017 Spectrum Brands, Inc.

REV: 12/17

PART NO: T22-0005588

